



Milano



Verona



ATTENZIONE

Si raccomanda di rivolgersi a un elettricista qualificato per installare il prodotto.

Si raccomanda di non toccare il prodotto quando è acceso.

In caso di malfunzionamento, staccare la lampada dall'alimentazione.

Si raccomanda di rivolgersi a un elettricista e di non provare a riparare la lampada da soli.

Specifiche tecniche:

Codice:	IP18PL4EKS	IP18PL8EKS
Dimensioni:	267*137*47mm	Ø222*47mm
Potenza:	18W	
Lumen:	1850Lm	
Switch 3CCT:	Sì	
Sorgente 3CCT:	3000K,4000K,6500K	
CRI:	80	
Funzione SA-SE:	Sì	
Potenza emergenza:	3W	
Lumen emergenza:	300lm	
Durata emergenza:	4h	
Tempo di ricarica:	+12h	
Flicker:	Free	
Grado IP:	IP65	
Classe:	II	
Dimmerabile:	No	

Plafoniere a LED di emergenza rotonde e ovali installabili facilmente a parete/soffitto. Corpo e diffusore V2 autoestinguente e Anti-UV in policarbonato termoplastico e staffa in lega di alluminio. Resistente agli urti (IK08).

1

MONTAGGIO

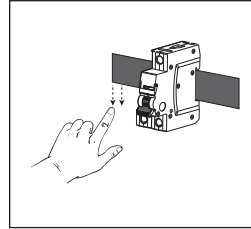

1. Scollegare la corrente elettrica.

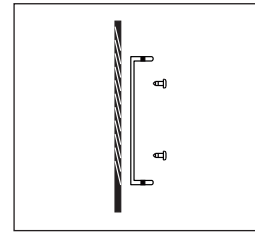

2. Effettuare i fori sul muro in base alla posizione del foro della staffa, posizionare la vite di espansione.

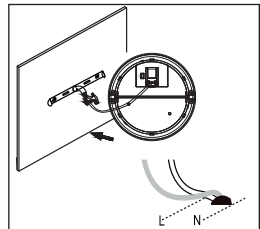

3. Scegliere la temperatura di utilizzo, connettere il cavo all'alimentazione.

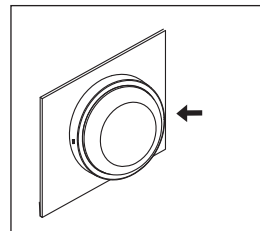

4. Fissare la lampada alla staffa e accendere l'alimentazione.

CONNESSIONE

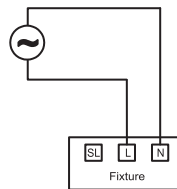

Emergenza non attivo.

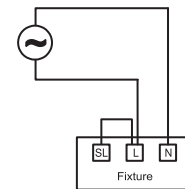

Emergenza attivo.

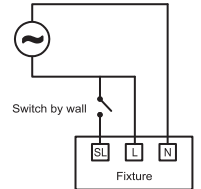

Emergenza attivo (commutabile).

- Quando la funzione emergenza è attiva, può essere disattivata per tre volte di seguito.
- Quando il prodotto viene utilizzato per la prima volta, la modalità di emergenza verrà attivata dall'illuminazione continua per più di 15 secondi.

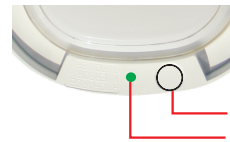

Indicatore LED

- Verde - Accesso
- Rosso - In carica
- Giallo - Errore

Informazioni sul riciclaggio in conformità con le direttive RAAE e batterie



Simbolo sul prodotto



Simbolo sulla batteria

Solo Europa

Il prodotto/batteria è contrassegnato con uno dei simboli di riciclaggio sopra indicati. Questo indica che a fine vita il prodotto/batteria, dovrà essere smaltito/a separatamente in appropriati luoghi di raccolta e non con i normali rifiuti domestici.

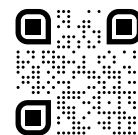
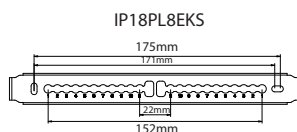
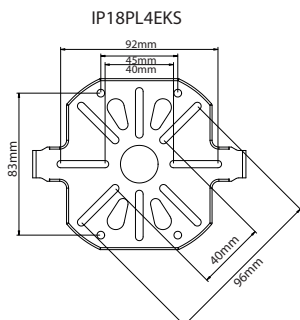

INSTRUCTION MANUAL CCT LED EMERGENCY BULKHEAD LIGHT IP65



⚠ WARNING

It is recommended to contact a qualified electrician to install the product.

It is recommended not to touch the product when it is turned on.

In case of malfunction, disconnect the lamp from the power supply. It is recommended to contact an electrician and not try to repair the lamp yourself.

MOUNTING

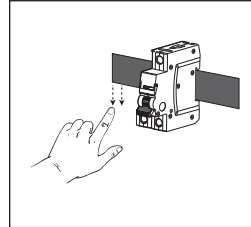

1. Switch off the power.

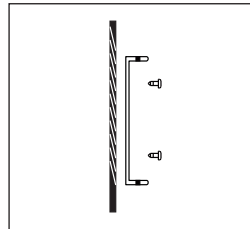

2. Pre-drilling on the wall according to the bracket hole position, put the expansion screw.

Specifications and Technical Data sheet:

Code:	IP18PL4EKS	IP18PL8EKS
Size:	267*137*47mm	Ø222*47mm
Power:	18W	
Lumen:	1850Lm	
CCT switch:	Yes	
CCT sources:	3000K,4000K,6500K	
CRI:	80	
SA-SE function:	Yes	
Emergency power:	3W	
Emergency lumen:	300lm	
Emergency time:	4h	
Charging time:	+12h	
Flicker free:	Yes	
IP Grade:	IP65	
Class:	II	
Dimmable:	No	

LED emergency bulkhead light round and oval, easy to install on the wall or ceiling. ANTI-UV and V2 Self-extinguishing thermoplastic PC housing and diffusor and aluminium alloy bracket. Resistant to impacts (IK08).

1

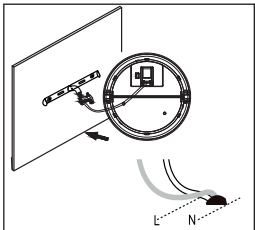

3. Choose the CCT temperature, connect the input wire to the production wire, reconnect metal bracket with fitting.

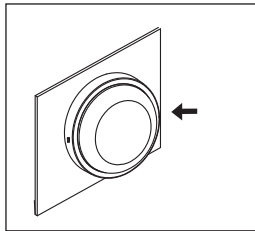

4. Fixed the lamp to the bracket and switch on the power.

CONNECTING INSTRUCTION

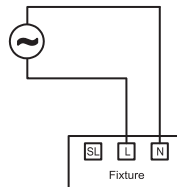

Emergency terminations non-maintained.

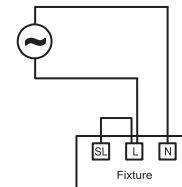

Emergency terminations maintained.

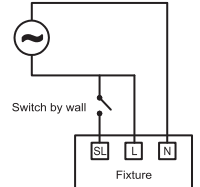

Emergency terminations maintained (switchable).

- When the emergency mode is activated, it can be turned off by turning the switch on and off continuously for three times.
- When first time use, the emergency mode will be activated by continuous lighting for more than 15 seconds.

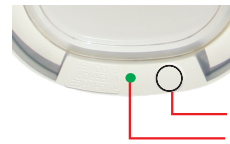

LED indicator

- Green - Power
- Red - Charge
- Yellow - Error

Recycling Information in Accordance with the WEEE and Battery Directives



Product Mark



Battery Mark

Europe only

The product/battery is marked with one of the above recycling symbols. It indicates that at the end of the life of the product/battery, you should dispose of it separately at an appropriate collection point and not place it in normal domestic waste stream.

